

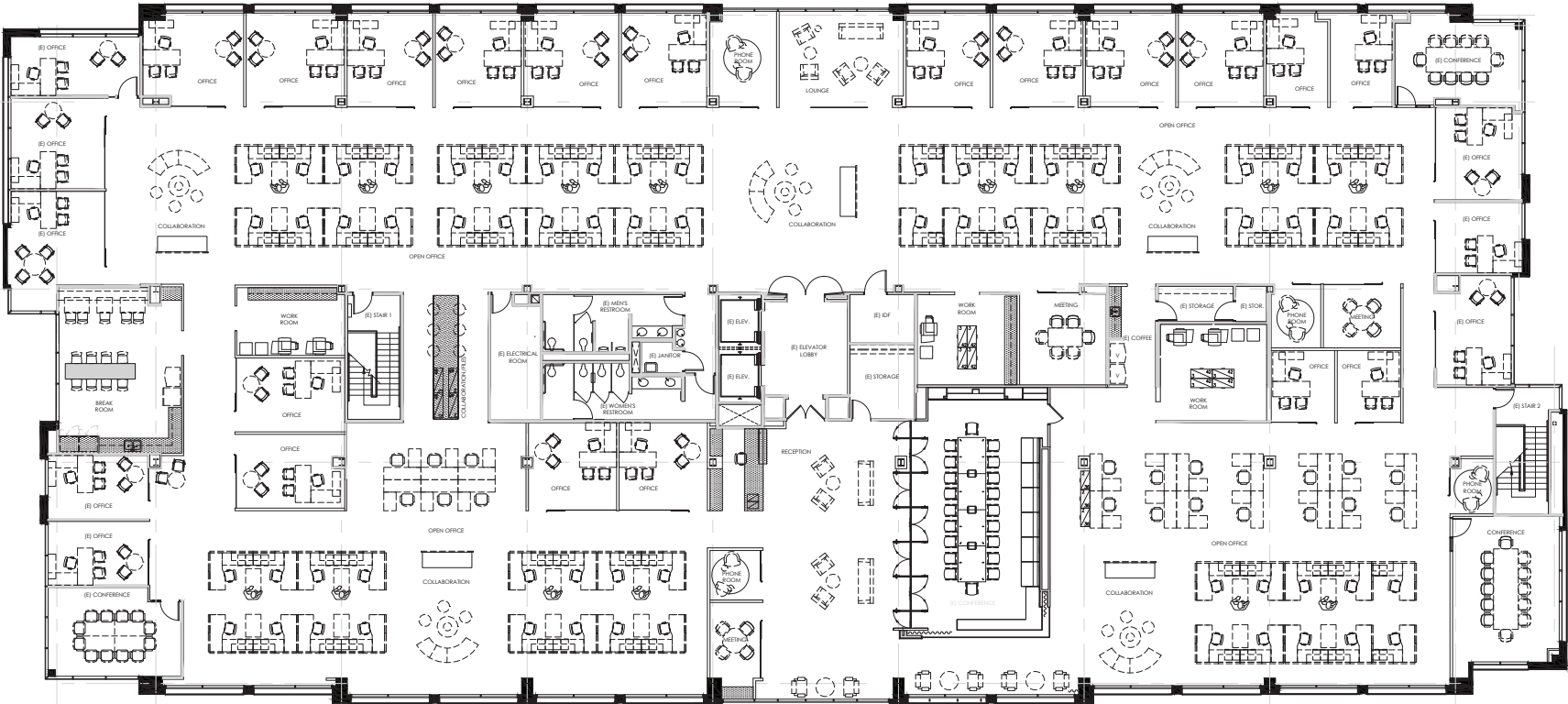

12265 El Camino Real

Hypothetical | Suite 300 | 27,448 r.s.f.



Tony Russell
tony.russell@am.jll.com
858.410.1213
Lic. No. 01275372

Bess Wakeman
bess.wakeman@am.jll.com
858.410.1245
Lic. No. 01177659



PASEO
DEL MAR